

We are **BUILDING THIS GYM!**



Round Rock Christian Academy opened a brand new 50,000 square foot facility in August, 2020. With a current enrollment of almost 700 students, RRCA Administration is pleased to be moving forward in Phase 2 with a groundbreaking event for the new Crusader Athletic Facility in February.

This 18,900 square foot facility will provide for the needs of RRCA's award winning athletic programs with a competition gym, retractable bleachers, locker rooms, weight room, training room and athletic offices. The building will also have space for a cafeteria, an outdoor courtyard eating area, concession stand, and will have the potential for future expansion. It will serve as a multi-purpose facility that can be used for athletic events, physical education classes, and special school events such as pep rallies, graduation, award ceremonies and student assemblies.



South View
(View from Front Entrance/Playground)

West View
(View from Classrooms)



ESTABLISH YOUR LEGACY WITH NAMING OPPORTUNITIES WITHIN THE FACILITY:

Cafeteria - \$75K

Outdoor Courtyard - \$50K

LED Video Display - \$50K

Scoreboard - \$25K

Training Room - \$10K

Athletic Offices - \$10K

**Donors for each opportunity listed above will be prominently and permanently recognized in the new facility.*

ADDITIONAL WAYS TO DONATE:

One Time Gifts:

Donate a one time gift through the school website or donate with cash or check directly to the Business Office. Please add "Gym Campaign" to the memo line on your check.

Schedule a Monthly Donation:

Commit to a monetary gift on a monthly basis for one full year. Payments can be made through the website or with cash or check.

Donor Wall Plaques:

Honor a special loved one with a personal inscription of your choice by purchasing a plaque on our Donor Wall in the Crusader Athletic Facility.

Sale of Stock:

Avoid capital gains with a gift of highly appreciated contributions while taking a full value deduction on your tax return.

Matching Gifts:

Maximize your donation through a matching gifts program through your employer.

We are BUILDING THIS GYM!

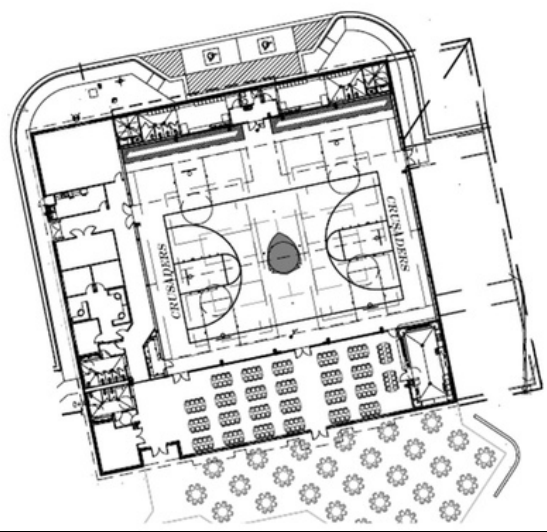

I WANT TO SUPPORT PHASE 2 OF THE FACILITY MASTER PLAN!

Name: _____

Address: _____

City / State / Zip: _____

Phone Number: _____

Email: _____

MY TOTAL PLEDGE: \$ _____

How do you want to make your pledge?

- ☐ One time donation
- ☐ \$ _____ per month for 12 months

I wish to give to this campaign by means of a gift other than cash:

Description: _____

Contact me for more info: _____

SIGNATURE: _____

DATE: _____